

## SMX Extended Body Straight Grinder



Ergonomic Design – Efficient Performance

[www.atatools.ie](http://www.atatools.ie)

# SMX

The new SMX range improves control, efficiency and reliability during heavy duty operations.

Similar to the recently developed SM and SMD lines, this double handed version benefits from ergonomic design which includes a new moulded front sleeve for improved insulation & operator comfort during operation. The SMX has a new robust Spider coupling design which transfers the motor power, speed and torque effectively through the spindle to the consumable. The ergonomics & efficiency of the SMX has been given careful consideration during the design process to ensure operator safety with optimum performance. As with the SM/SMD, the SMX range offers competitive repair costs with improved productivity.

The new throttle valve increases airflow and enables controlled startup.

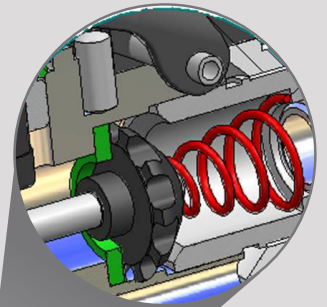

Front and rear exhaust options available.

New robust spider coupling to transfer power from the motor to the spindle.

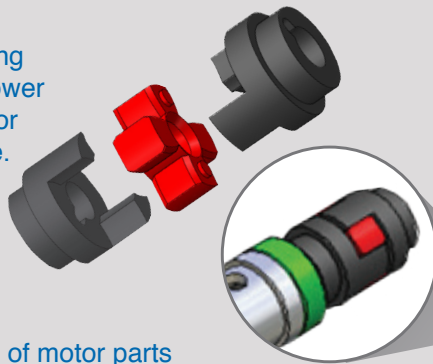

Commonality of motor parts with SM and SMD ranges.

New front and rear molded body design for improved aesthetics and insulation.

New Governor Design to provide speed range from 10,000 to 25,000rpm.

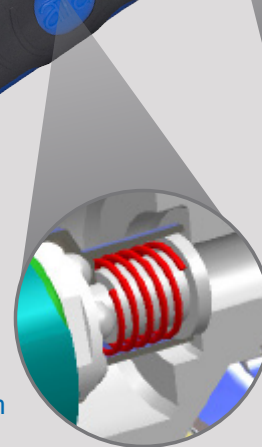

New spring loaded exhaust silencer system.

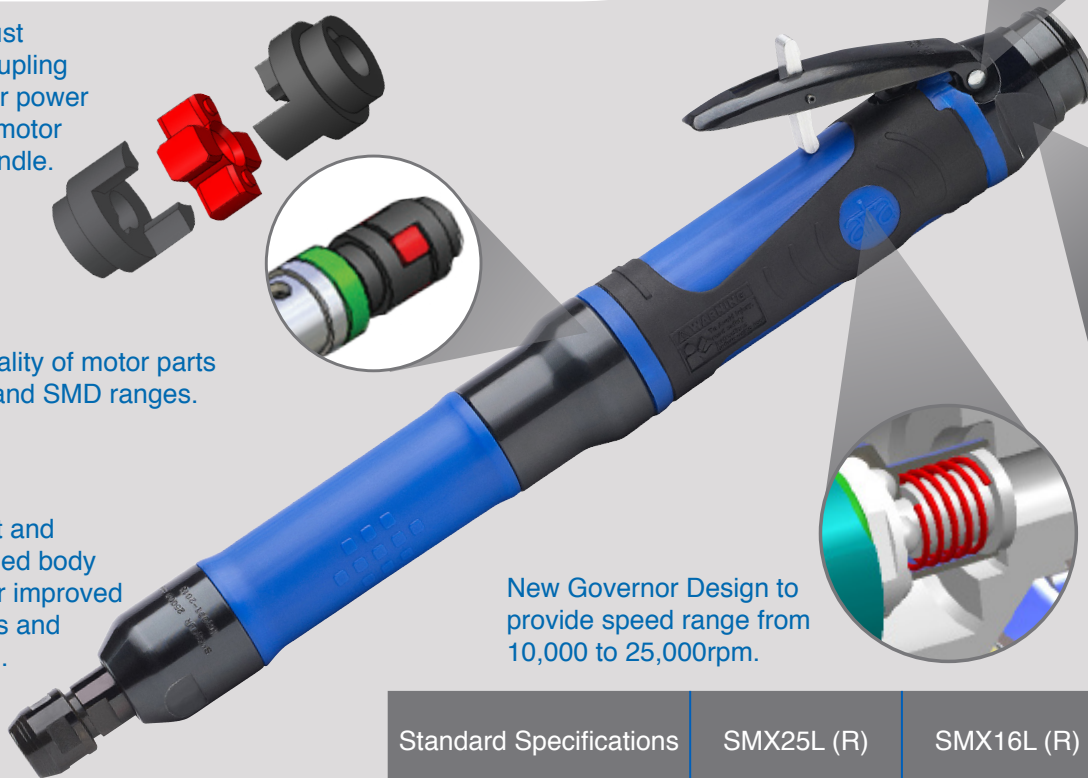

#### Applications:

- Heavy Deburring
- Grinding
- Sanding
- Polishing

#### Consumables:

- Burrs
- Mounted Points
- Fan Grinders
- Abrasive Bands
- Cartridge Rolls
- Wire Brushes

Standard Specifications	SMX25L (R)	SMX16L (R)	SMX10L (R)
Speed rpm	25,000	16,000	10,000
Power kW	0,82	0,82	0,82
Power hp	1,1	1,1	1,1
Weight kgs	1,3	1,3	1,3
Noise Level dbA	78(77)	77(75)	74(74)
Air Consumption cfm	22	22	22
Air Consumption m <sup>3</sup> /min	0,62	0,62	0,62
Exhaust Type	Front (Rear)	Front (Rear)	Front (Rear)
Length mm	345	345	345
Diameter	42	42	42